



A Division of Thiessen Products, Inc.

INSTRUCTION SHEET FOR #2188

INNER CAM BEARING INSTALLATION TOOL

USE ON SINGLE CAM BIG TWIN 1958-PRESENT



Refer to H.D.® Service Manual for removal of cam cover. Use cam cover puller, JIMS® #2243.

Caution: Use only Torrington® bearings, JIMS® #9058.

1. Lube threads, and screw #5 into plate #2. Install cam bearing driver tool #1 by threading it onto the end of screw #5. Push cam bearing tool #4 on end of driver #1.
2. Place cam bearing, letters and numbers out, on end of tool #4. Use a press fit lube on bearing.
3. Install assembled tool (with bearing) onto case using 2 allen screws from cam cover.
4. Lube threads and turn in screw # 5 carefully until bearing starts in bore. Tighten until tool contacts case. This will correctly locate bearing below case surface.
5. Use JIMS® tool #2249 for checking I.D. of bearing and JIMS® tool #2280 for checking cam alignment.

PARTS AVAILABLE SEPARATELY

No.	Qty.	Description	Part No.
1	1	TOOL, DRIVER, CAM BEARING	2190
2	1	PLATE	2188-1
3	1	SOCKET RING	2310
4	1	TOOL, CAM BEARING	97272-60
5	1	SCREW	1024
6	1	INSTRUCTIONS	2188-IS

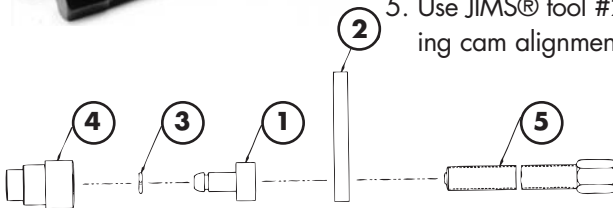

CAUTION: WEAR SAFETY GLASSES. EXCESSIVE FORCE MAY DAMAGE PARTS! ,SEE JIMS® CATALOG FOR OVER 100 OTHER TOP QUALITY PROFESSIONAL TOOLS. THE LAST TOOLS YOU WILL EVER NEED TO BUY.

"From the Track... To the Street!"

555 DAWSON DRIVE, CAMARILLO, CA 93012 • PHONE 805-482-6913 • FAX 805-482-7422



A Division of Thiessen Products, Inc.

INSTRUCTION SHEET FOR #2188

INNER CAM BEARING INSTALLATION TOOL

USE ON SINGLE CAM BIG TWIN 1958-PRESENT



Refer to H.D.® Service Manual for removal of cam cover. Use cam cover puller, JIMS® #2243.

Caution: Use only Torrington® bearings, JIMS® #9058.

1. Lube threads, and screw #5 into plate #2. Install cam bearing driver tool #1 by threading it onto the end of screw #5. Push cam bearing tool #4 on end of driver #1.
2. Place cam bearing, letters and numbers out, on end of tool #4. Use a press fit lube on bearing.
3. Install assembled tool (with bearing) onto case using 2 allen screws from cam cover.
4. Lube threads and turn in screw # 5 carefully until bearing starts in bore. Tighten until tool contacts case. This will correctly locate bearing below case surface.
5. Use JIMS® tool #2249 for checking I.D. of bearing and JIMS® tool #2280 for checking cam alignment.

PARTS AVAILABLE SEPARATELY

No.	Qty.	Description	Part No.
1	1	TOOL, DRIVER, CAM BEARING	2190
2	1	PLATE	2188-1
3	1	SOCKET RING	2310
4	1	TOOL, CAM BEARING	97272-60
5	1	SCREW	1024
6	1	INSTRUCTIONS	2188-IS

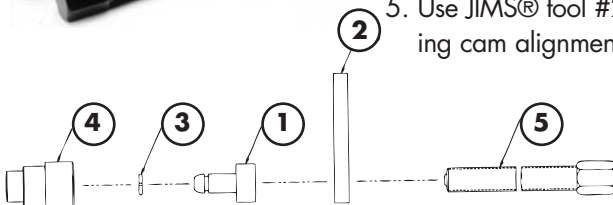

CAUTION: WEAR SAFETY GLASSES. EXCESSIVE FORCE MAY DAMAGE PARTS! ,SEE JIMS® CATALOG FOR OVER 100 OTHER TOP QUALITY PROFESSIONAL TOOLS. THE LAST TOOLS YOU WILL EVER NEED TO BUY.

"From the Track... To the Street!"

555 DAWSON DRIVE, CAMARILLO, CA 93012 • PHONE 805-482-6913 • FAX 805-482-7422