

A Division of Thiessen Products, Inc.

INSTRUCTION SHEET FOR #97081-54

SPROCKET SHAFT BEARING INSTALLATION TOOL

USE ON SPORTSTERS AND K MODELS 1954-1976

Refer to H-D® Service Manual for specifications.



1. With flywheels ready to go into the left case, and clamped in vice.

2. Lube sprocket shaft bearing area with Press Fit Lube, and ID of bearings.

3. Install the bearing over sprocket shaft and inner bearing spacer. Lube tool main body No. 1 threads, ID and OD. Thread main body onto sprocket shaft with handle No. 4 as far as possible.

4. Slip slider No. 3 over main body No. 1. Next install lubed bearing and washer No. 5 with bearing in between the two washers. Thread nut assembly No. 2 onto main body and tighten until bearing bottoms on shaft shoulder using JIMS® tool 94660-37A, and torque to H-D® specification. If you run out of thread on the shaft, or if you are installing bearings on a 1977-present, use JIMS®

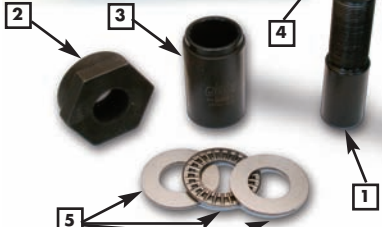

tool No. 37047-91-5 slider at 2.060 long, or No. 37047-91-6 slider at 2.500 long, as needed to get bearings seated on shaft.

5. After you have installed the case and the last bearing, torque to H-D® specifications(see H-D® Service Manual for end play and torque specifications).

PARTS AVAILABLE SEPARATELY

| No. | Qty. | Description | Part No. |
|-----|------|-------------------|------------|
| 1 | 1 | MAIN BODY | 97081-54-1 |
| 2 | 1 | NUT | 1026-B |
| 3 | 1 | SLIDER | 97081-54-3 |
| 4 | 1 | LONG HANDLE | 1028 |
| 5 | 1 | BEARING & WASHERS | 1047-54 |

"Doing It Right... The JIMS® Way!"

555 DAWSON DRIVE, CAMARILLO, CA 93012 • PHONE 805-482-6913 • FAX 805-482-9224

VISIT US ON THE WEB AT WWW.JIMSUSA.COM



A Division of Thiessen Products, Inc.

INSTRUCTION SHEET FOR #97081-54

SPROCKET SHAFT BEARING INSTALLATION TOOL

USE ON SPORTSTERS AND K MODELS 1954-1976

Refer to H-D® Service Manual for specifications.

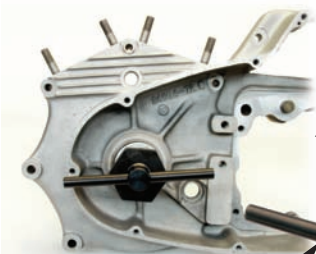

1. With flywheels ready to go into the left case, and clamped in vice.

2. Lube sprocket shaft bearing area with Press Fit Lube, and ID of bearings.

3. Install the bearing over sprocket shaft and inner bearing spacer. Lube tool main body No. 1 threads, ID and OD. Thread main body onto sprocket shaft with handle No. 4 as far as possible.

4. Slip slider No. 3 over main body No. 1. Next install lubed bearing and washer No. 5 with bearing in between the two washers. Thread nut assembly No. 2 onto main body and tighten until bearing bottoms on shaft shoulder using JIMS® tool 94660-37A, and torque to H-D® specification. If you run out of thread on the shaft, or if you are installing bearings on a 1977-present, use JIMS®

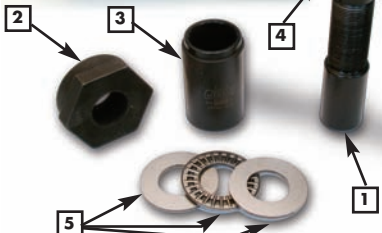

tool No. 37047-91-5 slider at 2.060 long, or No. 37047-91-6 slider at 2.500 long, as needed to get bearings seated on shaft.

5. After you have installed the case and the last bearing, torque to H-D® specifications(see H-D® Service Manual for end play and torque specifications).

PARTS AVAILABLE SEPARATELY

| No. | Qty. | Description | Part No. |
|-----|------|-------------------|------------|
| 1 | 1 | MAIN BODY | 97081-54-1 |
| 2 | 1 | NUT | 1026-B |
| 3 | 1 | SLIDER | 97081-54-3 |
| 4 | 1 | LONG HANDLE | 1028 |
| 5 | 1 | BEARING & WASHERS | 1047-54 |

"Doing It Right... The JIMS® Way!"

555 DAWSON DRIVE, CAMARILLO, CA 93012 • PHONE 805-482-6913 • FAX 805-482-9224

VISIT US ON THE WEB AT WWW.JIMSUSA.COM