

INSTRUCTION SHEET FOR 5-SPEED CLEAN CUT GEAR SET

THIS INSTRUCTION SHEET COVERS THE FOLLOWING GEAR SETS. →



STANDARD RATIO	CLOSE RATIO
1980-84 No. 8044	No. 8045
1985-89 No. 8046	No. 8047
1990+ No. 8015*	No. 8016*

*Fits Twin Cam88™

JIMS® TOOLS REQUIRED:

No.2234	Primary Drive Locking Tool
No.94660-37A	Main shaft Sprocket Wrench
No.2260	Big Twin Sprocket Locker
No.34902-84	Main shaft Bearing Race Tool
No.35316-80	5-speed Transmission Main Drive Gear Tool
No.2189	5-Speed Shaft Installer
No.2283	Door puller
No.2362	Lock ring pliers
No.1078	Door Bearing Remover / Installer

Refer to H-D® Service Manual for specifications, disassembly, assembly instruction per model application.
(NOTE: Read all instructions before performing work.)

COMPLETE 5 SPEED FORDGED GEAR SETS "CLEAN CUT FORGED GEARS"

Gear sets for 5 speed Big Twin transmissions includes all gears and shafts. Available with stock or close ratio first gears. These are the same precision gears used in our complete transmissions and super kits.

JIMS offers complete transmission rebuild kits for all five-speed models. These kits include all bearings, seals, retainer rings, spacers, and gaskets.

No.1019	For 1980 to early 1984 Big Twin 5-Speed
No.1020	For late 1984 to 1990 Big Twin 5-Speed
No.1021	For 1991 to 1998 Big Twin 5-Speed
No.1035	For 1999 to Present Twin Cam 5-Speed

PARTS LIST

No.	QTY	TITLE OR DESCRIPTION	REFERENCE	JIMS PART NUMBER
1	1	MAINSHAFT	35042-91	35042-91
2	1	COUNTERSHAFT	35632-79	35632-79
3	1	GEAR, MAINSHAFT 1ST	35025-CR or 35025-79B	35025-CR or 35025-79B
4	1	GEAR, MAINSHAFT 2ND	35026-79C	8291
5	1	GEAR, MAINSHAFT 3RD	35027-79B	8292
6	1	GEAR, MAINSHAFT 4TH	35028-79B	8294
7	1	GEAR, MAINSHAFT 5TH	35029-79, 35029-85A, or 35029-91A	8298, 8297, 8296
8	1	GEAR, COUNTERSHAFT 1ST	35622-79C or 35622-CR	35622-79C, 35622-CR
9	1	GEAR, COUNTERSHAFT 4TH	35625-79B	35625-79B
10	1	GEAR, COUNTERSHAFT 5TH	35626-79B	8299
11	1	GEAR, COUNTERSHAFT 2ND	35027-79B	8292
12	1	GEAR, COUNTERSHAFT 3RD	35026-79C	8291
13	1	INSTRUCTION SHEET		8015-IS

CAUTION: WEAR SAFETY GLASSES. EXCESSIVE FORCE MAY DAMAGE PARTS!
SEE JIMS® CATALOG FOR HUNDREDS OF TOP QUALITY PROFESSIONAL TOOLS.
THE LAST TOOLS YOU WILL EVER NEED TO BUY.

Performance Parts For Harley-Davidson® Motorcycles

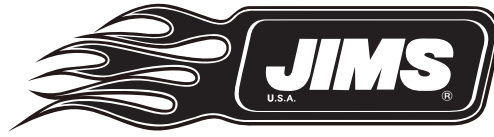

INSTRUCTION SHEET FOR 5-SPEED CLEAN CUT GEAR SET

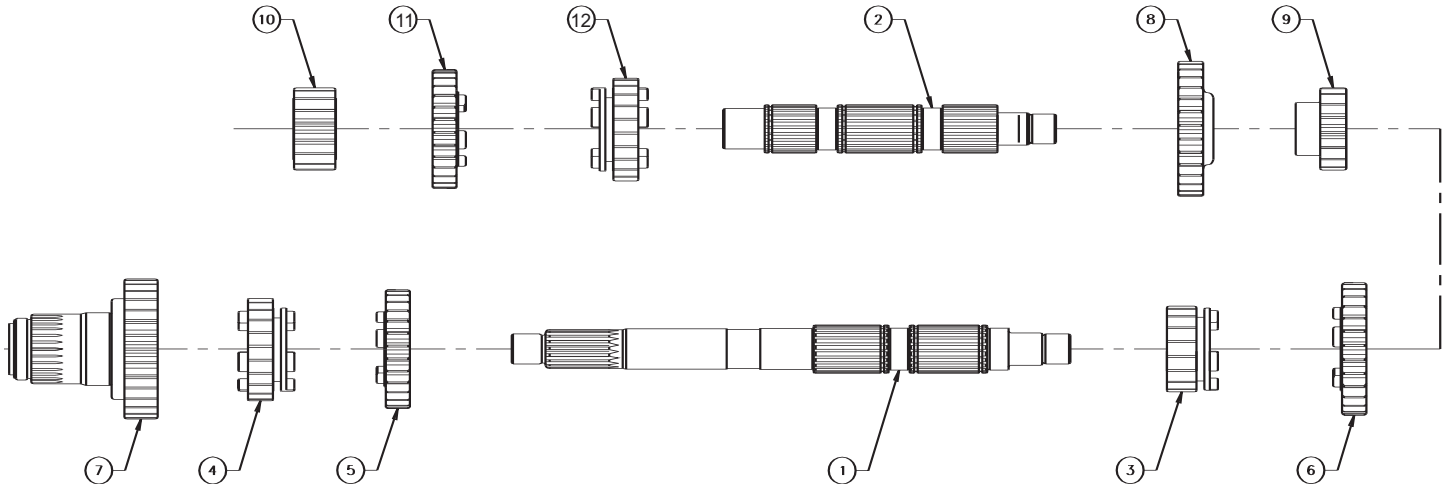

FIGURE 1
5-SPEED CLEAN-CUT GEARS

WARRANTY

All JIMS® parts are guaranteed to the original purchaser to be free of manufacturing defects in material and workmanship for a period of six (6) months from the date of purchase. Merchandise that fails to conform to these conditions will be repaired or replaced at JIMS® option the parts are returned within the six (6) months warranty period or within ten (10) Days thereafter.

In the event warranty service is required, the original purchaser must call or write JIMS® immediately with the problem. Some problems can be rectified by a telephone call and need no further course of action. A part suspected of being defective must not be replaced by a dealer without prior authorization by JIMS®. If it is deemed necessary for JIMS® to make an evaluation to determine whether the part is defective, it must be packaged properly to prevent further damage and be returned prepaid to JIMS® with a copy of the original invoice of purchase and a detailed letter outlining the nature of the problem, how the part was used and the circumstances at the time of failure. If after an evaluation has been made by JIMS® and the part was found to be defective, repair, replacement or credit will be granted.

ADDITIONAL WARRANTY PROVISIONS

1. JIMS® shall have no obligation in the event a JIMS® part is modified by person or organization.
2. JIMS® shall have no obligation if a JIMS® part becomes defective in whole or in part as a result of improper installation, improper maintenance, improper use, abnormal operation, or any other misuse or mistreatment of the part.
3. JIMS® shall not be liable for any consequential or incidental damages resulting in the failure of a JIMS® part, the breach of any warranties, the failure to deliver, delay in delivery, delivery in nonconforming condition, or for any other breach of contract or duty between JIMS® and a customer.
4. JIMS® parts are designed exclusively for use in Harley-Davidson® motorcycles. JIMS® shall have no warranty or liability obligation if JIMS® part is used in any other application.
5. Any parts or tool replaced by JIMS® becomes the property of JIMS® and will not be returned under any circumstance.

CAUTION: WEAR SAFETY GLASSES. EXCESSIVE FORCE MAY DAMAGE PARTS!
SEE JIMS® CATALOG FOR HUNDREDS OF TOP QUALITY PROFESSIONAL TOOLS.
THE LAST TOOLS YOU WILL EVER NEED TO BUY.

Performance Parts For Harley-Davidson® Motorcycles