

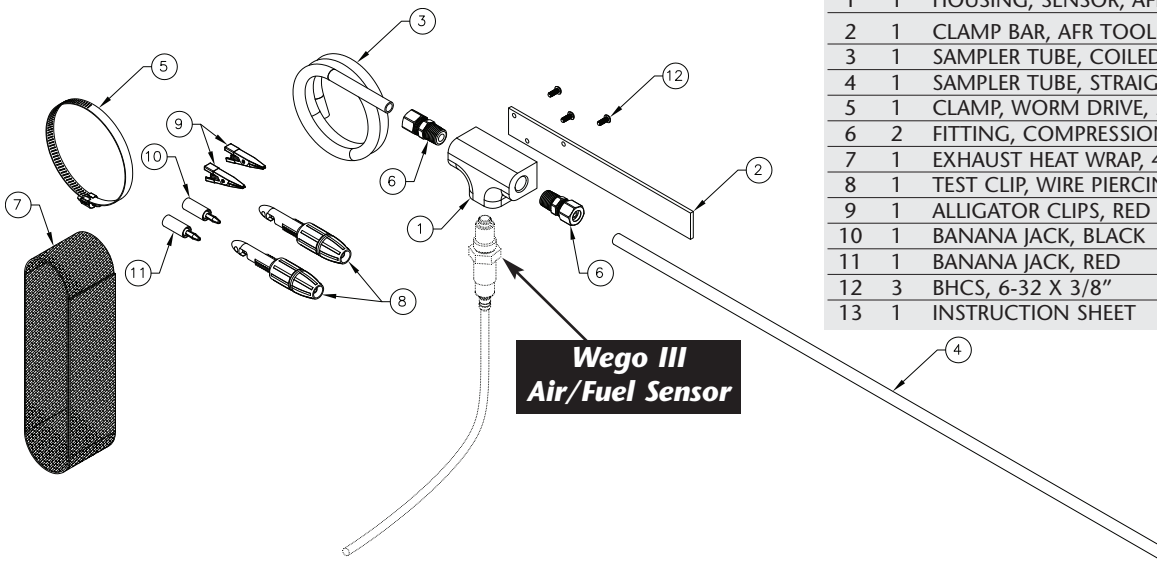

A Division of Thiessen Products, Inc.

INSTRUCTION SHEET FOR TOOL #777



APPLICATION AND PARTS CHART			
NO.	QTY.	DESCRIPTION	PART NO.
1	1	HOUSING, SENSOR, AFR TOOL	777-1
2	1	CLAMP BAR, AFR TOOL	777-2
3	1	SAMPLER TUBE, COILED	777-3
4	1	SAMPLER TUBE, STRAIGHT	777-4
5	1	CLAMP, WORM DRIVE, 2-1/2" - 5-1/2"	777-5
6	2	FITTING, COMPRESSION	777-6
7	1	EXHAUST HEAT WRAP, 4"X21"	777-7
8	1	TEST CLIP, WIRE PIERCING, RED & BLACK	777-8
9	1	ALLIGATOR CLIPS, RED & BLACK	777-9
10	1	BANANA JACK, BLACK	777-10
11	1	BANANA JACK, RED	777-11
12	3	BHCS, 6-32 X 3/8"	1247
13	1	INSTRUCTION SHEET	777-IS

JIMS AFR (AIR FUEL RATIO) DIAGNOSTIC SNIFFER

This tool is used with the Daytona Twin Tech Wego III Wide Band AFR, (air fuel ratio) Monitor System. JIMS No.773 requires some minor assembly before usage.

No.773 - Use on any motorcycle that does not have a catalytic converter.

Tools and shop supplies needed to assemble:

- 5/8" Box / Open Combination wrench
- 5/64" Allen wrench
- Wire stripper tool
- 9/16" Box / Open Combination wrench
- Medium size flat blade screwdriver
- Blue Loctite or equivalent

Assembly of tool:

1. Apply blue Loctite to the three No.1247 screws and use them and your 5/64" Allen wrench to mount muffler clamp bar No.777-2 to the sensor housing No.777-1.
2. Apply blue Loctite to the longest threaded side of each No.777-6 compression fittings only. Then using your 9/16" wrench, thread both compression fittings No.777-6 into each end of the sensor housing No.777-1. as shown in figure above.

**NOTE: PLEASE READ ALL INSTRUCTIONS COMPLETELY BEFORE PERFORMING ANY WORK!
IF YOU DO NOT KNOW WHAT YOU ARE DOING, DO NOT DO IT!**

No information in this instruction sheet pertaining to motorcycle repair is represented as foolproof or even altogether safe. Even something safe, done incorrectly or incompletely can and will backfire. You and only you are responsible for the safety of your repair work and for you understanding the application and use of repair equipment, components, methods and concepts.

Each and every step this tool is designed to do must be carefully and systematically performed safely by you. All information listed in this instruction sheet has been tested, re-tested and used daily in JIMS® Research and Development Department.

ALWAYS WEAR SAFETY GLASSES OR OTHER FACE AND EYE PROTECTION SUCH AS FULL FACE SHIELD. JIMS® IS NOT RESPONSIBLE FOR DAMAGE, INJURY, OR YOUR WORK. JIMS® IS NOT RESPONSIBLE FOR THE QUALITY AND SAFETY OF YOUR WORK.

Performance Parts For Harley-Davidson Motorcycles



A Division of Thiessen Products, Inc.

INSTRUCTION SHEET FOR TOOL #777

3. Next take one nut from the tube end of the compression fittings No.777-6 and slide one onto the long straight sniffer tube. When installing the nut onto the tube, install the smaller end of the nut end on the tube first. Now slide the ferrule onto the same tube about an 1/8" from the end, then slide the nut down to the ferrule and thread onto the sensor housing as shown in the figure. Tighten nut with your 1/8" wrench.
4. Follow the same steps in step 4 to install brass coil No.777-3, the ferrule, and nut, with compression fitting to the other side of the sensor housing No. 777-1 as shown in figure.

Using JIMS tool for AFR testing:

1. Connect the Wego III sensor to the sensor housing No.777-1 by threading on as shown.
2. When mounting the sniffer tool to a muffler you will need to use No.777-7 exhaust wrap around the muffler or pipes to protect the finish. Wrap around the muffler a couple of times before installing the clamp No. 777-5 to hold the sniffer clamp bar tight against the muffler or pipes. See the instruction in Wego III AFR tool for other examples of how to mount the sniffer to the muffler.
3. Refer to Daytona Tech Wego III instructions on how to use the sniffer and Wego III program.

**CAUTION: WEAR SAFETY GLASSES OVER YOUR EYE'S.
SEE JIMS® CATALOG FOR HUNDREDS OF TOP QUALITY PROFESSIONAL TOOLS.
THE LAST TOOLS YOU WILL EVER NEED TO BUY.**

Performance Parts For Harley-Davidson Motorcycles