



A Division of Thiessen Products, Inc.

# INSTRUCTION SHEET FOR No.5447

No. 5447 is the special hardware kit used when mounting the JIMS Forceflow Cylinder Cooler on any of JIMS Race Engines.

Read these instructions before installation of this product. You will also need to refer to the Instructions from the Forceflow Cylinder Head Cooler Assembly No. 5400-IS. If you have not received this instruction sheet, it is available at [www.jimsusa.com](http://www.jimsusa.com) or call JIMS Sales Dept.

1. **See Fig. 1** and refer to Part number call-out bubbles and parts list for assembly reference.
2. Remove stock center case bolt from your JIMS Race Engine.
3. For the JIMS Race Cases you need to locate the 1/4-20 case stud No. 5415 (provided).
4. Apply Blue threadlocker to the threads on the end of the stud **without** the slot on it.
5. Insert the non-slotted end of stud No. 5415 into the top center case bolt hole and tighten stud snug with a flat blade screwdriver. Slide washer No. 5437 onto stud.
6. Apply blue threadlocker to jam nut No. 1682 and thread onto stud. Torque to 11-13 ft-lbs using a 7/16" deep socket and torque wrench.
7. Next, install AN-washer No. 5437 onto No. 5414 stud against jam nut, and then No. 5409 lower mount bracket. Install another washer No.5437 onto stud.
8. Apply blue Threadlocker to acorn nut No. 5438 and install onto the stud. Tighten the lower bracket in the correct upright position. **See Fig 2**
9. Now tighten with a 7/16" socket and torque wrench. Torque to 11-13 ft-lbs.

**Warning!** Some aftermarket shift linkage rods may interfere with the lower mounting bracket. Be sure to check for adequate clearance before riding. It is necessary to use a round shift rod to maintain adequate clearance.

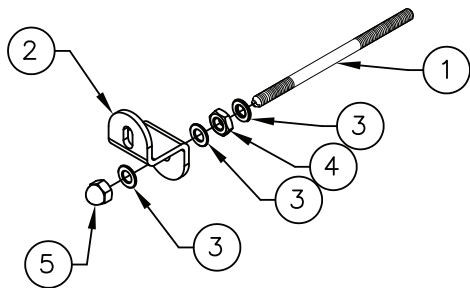

PARTS LIST			
NO.	QTY.	TITLE OR DESCRIPTION	PART NUMBER
1	1	STUD, CASE, 1/4-20, CYLINDER COOLER	5415
2	1	MOUNT, LOWER, MOTOR JIMS, ZINC	5409
3	4	WASHER, FLAT, 1/4", AN	5437
4	1	NUT, 1/4-20, JAM	1682
5	1	NUT, ACORN, 1/4-20	5438
6	1	INSTRUCTION SHEET	5447-IS

**FIG. 1**

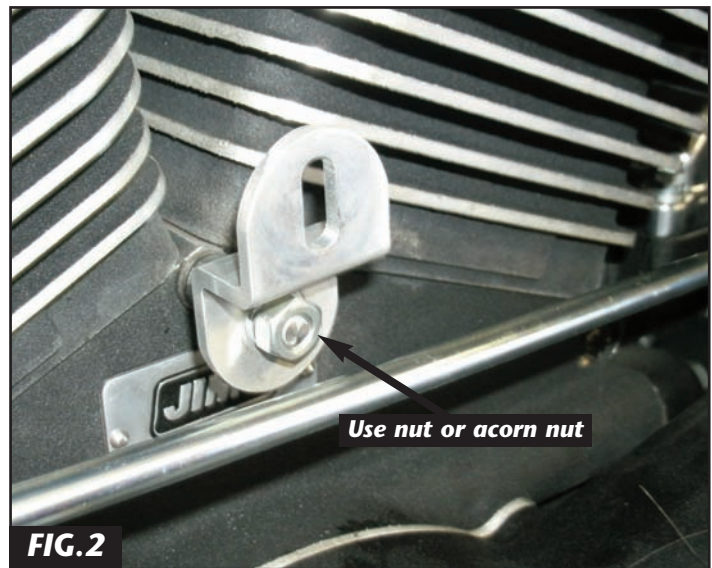

**FIG. 2**

**CAUTION: WEAR SAFETY GLASSES OVER YOUR EYES.**  
 SEE JIMS® CATALOG FOR HUNDREDS OF TOP QUALITY PROFESSIONAL TOOLS.  
 THE LAST TOOLS YOU WILL EVER NEED TO BUY.

*Performance Parts For Harley-Davidson Motorcycles*